



STONECREST
at Norwood

229 STONECREST WAY
PITTSBORO, NC 27312
919-278-7655

stonecrestatnorwood.com

HOMESITE 47 FLOOR PLAN | PRICE: \$749,900



FEATURES

- *1st floor master and guest suite*
- *4 bedrooms*
- *4.5 baths*
- *Huge screened porch with very private wooded backyard*
- *Open floor plan*
- *Side entry door w/ covered porch into mudroom*
- *3 car garage w/ ample storage closet*
- *1.92 acre homesite*
- *Beautiful stone veneer*

This executive-styled custom ranch features dual covered front porch entrances, providing easy access to the sprawling first floor. You will never want to leave the owner's suite with its spa-like owner's bath and dual walk-in closets. The gourmet kitchen and oversized island flow seamlessly into a spacious breakfast room and giant family room. And the formal dining and living rooms coupled with a first-floor guest suite allow you to live and entertain on one level. Moving upstairs, you'll find two more bedrooms with full bathrooms, a massive 17' by 18' recreation room, and 800 square feet of storage. Did we mention the family-room-sized screened porch with gorgeous views of the heavily-wooded backyard? This home will be ready for you to move in by March 2019!

Custom Built By:  **WAGONER**
HOMES



STONECREST at Norwood

HEATED SQ FT: **3,888 SF** STORAGE: **800 SF** GARAGE: **3 CAR** ACRES: **1.92**

1st

FIRST FLOOR
Ceilings: 10'

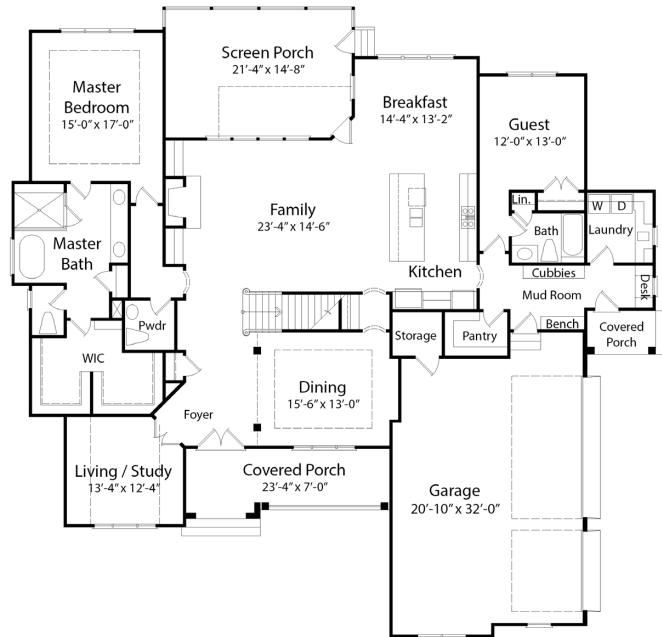

2nd

SECOND FLOOR
Ceilings: 9'

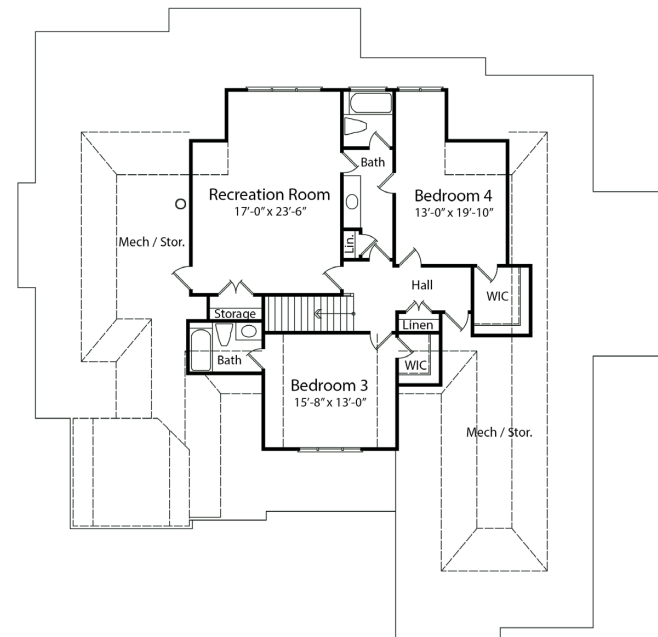

All details, dimensions, square footage and illustrations are approximate and may vary from actual plans and specifications.

PROUDLY DEVELOPED BY



SALES AND MARKETING BY

